

LOCATION MAP  
SCALE: NTS

INDEX	
ARCHITECTURAL	
A-0	GENERAL CONDITIONS
A-1	FLOOR PLAN
ELECTRICAL	
E-1	ELECTRICAL PLAN
E-2	LOAD SCHEDULE
LIFE SAFETY	
LS-1	LIFE SAFETY PLAN
MECHANICAL PLAN	
M-1	MECHANICAL PLAN-EXIST
PLUMBING LAYOUT	
P-1	PLUMBING LAYOUT-EXIST
P-2	PLUMBING - HC DTL

**LEGAL DESCRIPTION**  
 Lots 21, 22 and the south 20 feet of the lots 1 and 2 Block 83 of FULFORD BY THE SEA SECTION "F" according to the plot thereof as recorded on PLOT Book B at page 64, of the public records of Miami dade County, Florida

**CODE COMPLIANCE**  
 ALL WORK IS DESIGNED TO CONFORM TO:  
 - FLORIDA BUILDING CODE 7th EDITION (2020) - BUILDING  
 - LAND USE- MU/TC FULFORD MIXED USE TOWN CENTER  
 - F.F.P.C 7th EDITION (2020) - BASED ON NFPA 101 2015 EDITIONS  
 - A.S.C.E. 7-10  
 - NEC 2017-NFPA 70  
 - ZONED-MU/TC

**BUILDING/SITE DATA**  
 1 STORY CBS CONSTRUCTION  
 TYPE OF USE: SCHOOL  
 OCCUPANCY GROUP: GROUP E- EDUCATIONAL  
 CONSTRUCTION TYPE: TYPE II  
 GROSS SITE AREA: 18482 SF  
 GROSS BUILDING AREA: 4376 SF

**SCOPE OF WORK**  
 PROPOSED CHANGE OF OCCUPANCY FROM B TO E

**ALTERATION LEVEL**  
 ALTERATION LEVEL 1

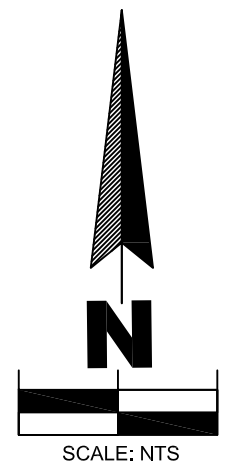

**PARKING CALCULATIONS**  
 MAX NO STUDENTS ----- 50  
 NUMBER STUDENTS / 4 = 13 RQ'D PKG  
 NUMBER PARKING PROVIDED ----- 29 PKG

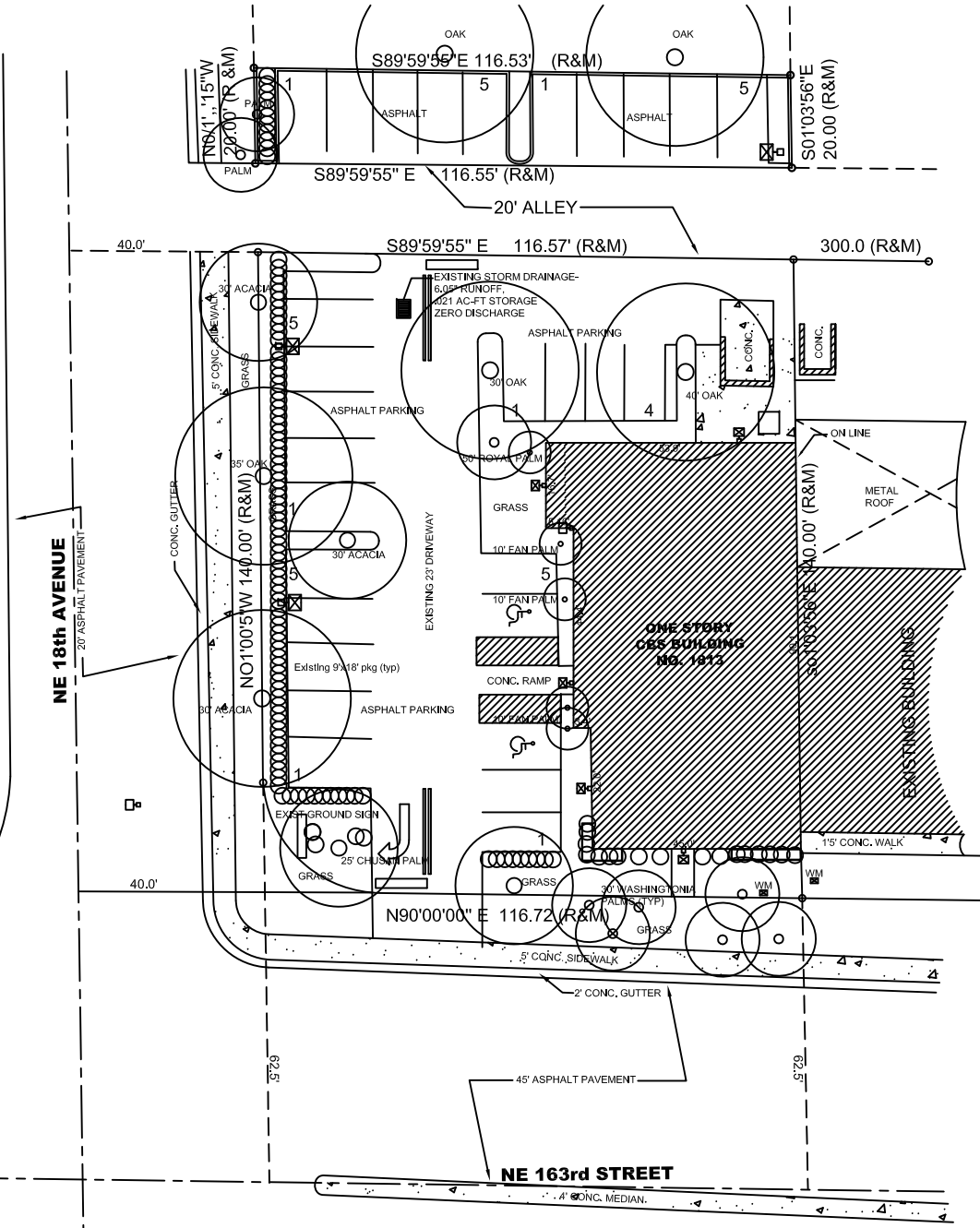

REVISIONS  
 00-00-0000

ARCHITECT  
 AR 0013230

GENERAL CONTRACTOR  
 CG CA56762

ROOFING  
 CC CA56762

**J.F. SMITH**  
 DESIGN & BUILD INC.

1102 SW 6TH STREET, Fort Lauderdale, Florida 33312 - 954-566-4790, jsmithdb@gmail.com

**NORTH ACADEMY**  
 1813 NE 163 ST.  
 NORTH MIAMI BEACH,  
 FL 33162

SHEET  
**A-0**